



SALUDA LAND & LUMBER CO.

S 5-0 E 650' - Total

Pipe in Locust Stump

SALUDA LAND & L.S.R. CO.  
S 59-45 E 270'

MRS. JOHN GOSNELL  
Pipe  
128'  
158-0 E  
216'  
43  
58-30 E  
675'  
Stone  
Branch to Line

AREA 9.09 ACRES  
W. C. Yount to City of Greenville, S.C.

NORTH

FULLER

PROPERTY OF  
CITY OF GREENVILLE  
TURNER SHOALS TRACT  
GREENVILLE CO. S.C.

Scale 1"=100' June 1925

DALTON & NEVES, ENGINEERS

F. Bank No. 96  
JOB NO. 1208-1

Recorded Nov. 19, 1925 by Key Data  
(11:15 A.M.)

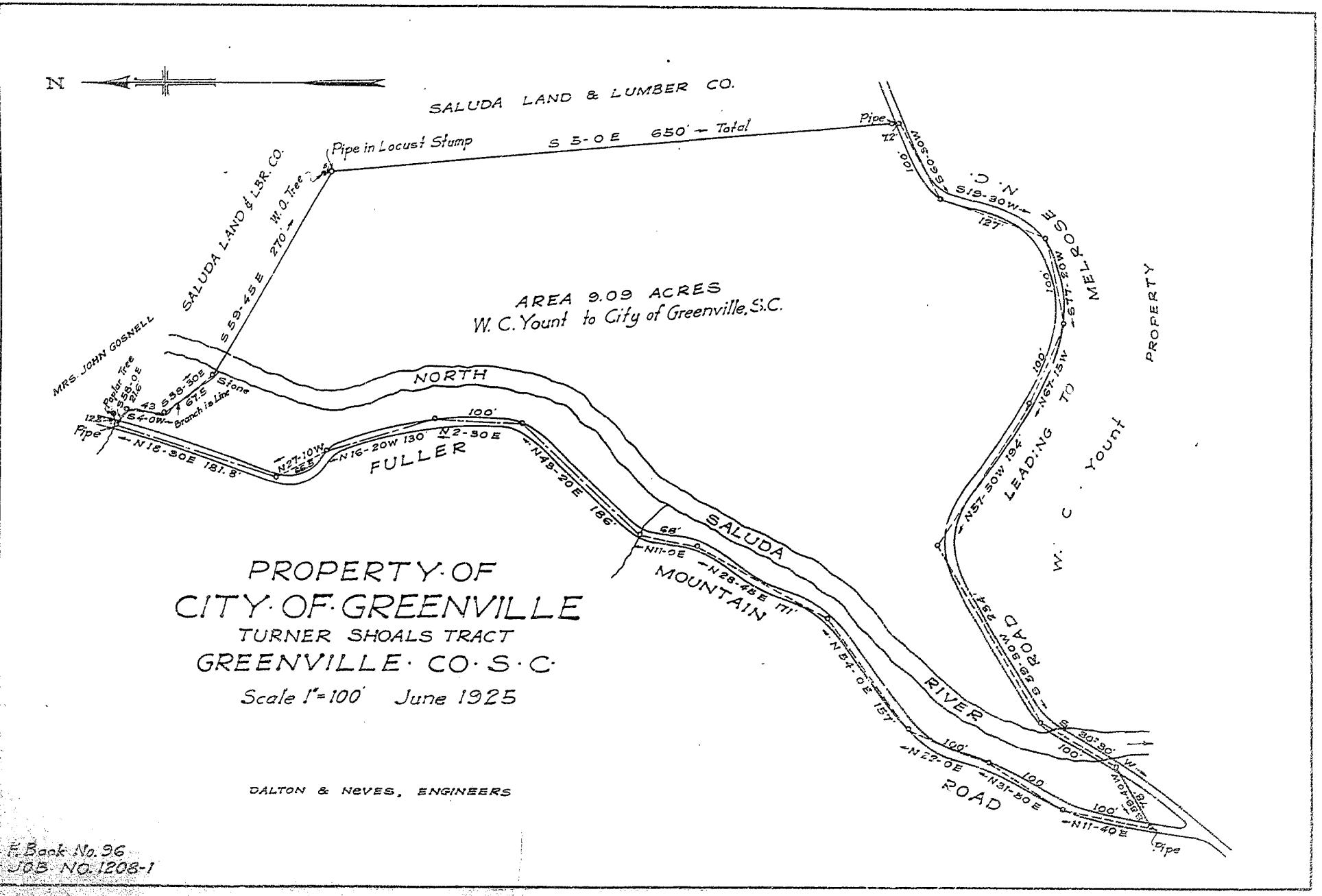

PROPERTY

W. C. Yount  
LEADING TO

ROAD

6