

28506

NOV 24 1950

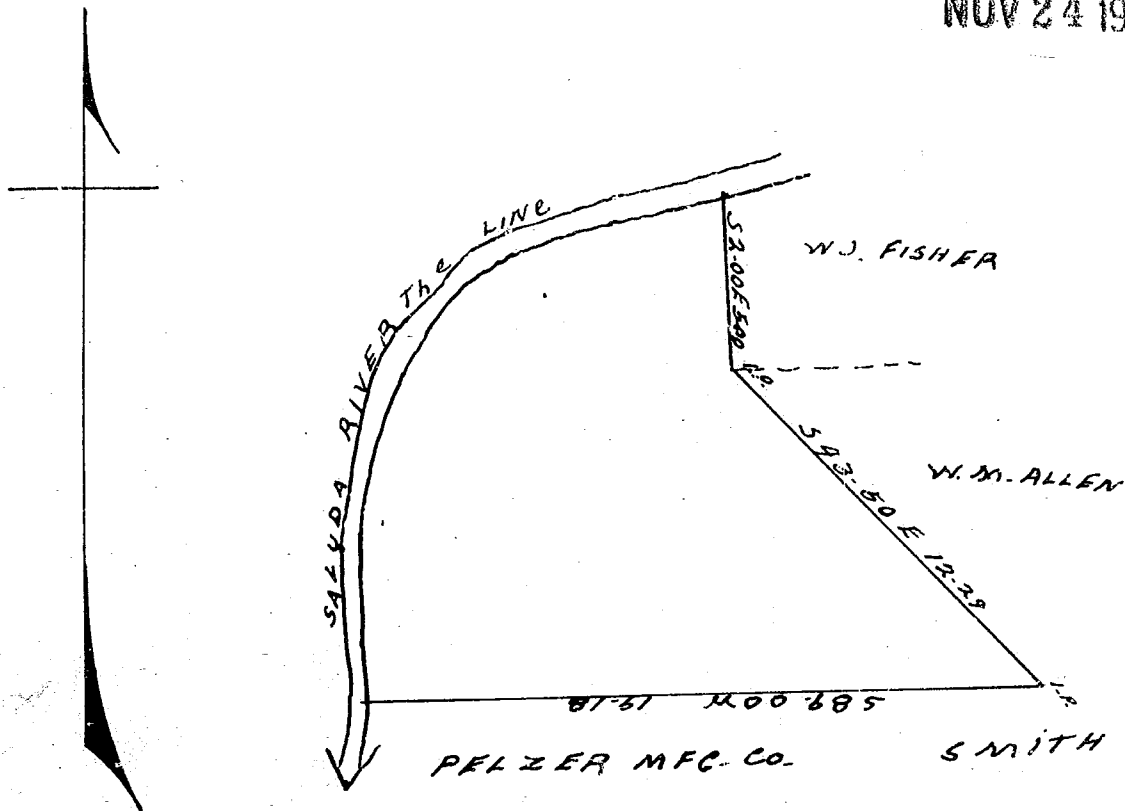

State of South Carolina
Greenville County

The above plat represents a portion of W. M. Allen land. Said portion is to be deeded to J. R. Davis. All lines except division line taken from deed. Said tract contains (24.12) acres more or less. Division line run

by me. Nov. 4, 1950

J. Cole Smith

Reg. L.S. No. 974

1" = 5 CHAINS