

Y-43

CONTINUED FROM DWG. NO. 100-82

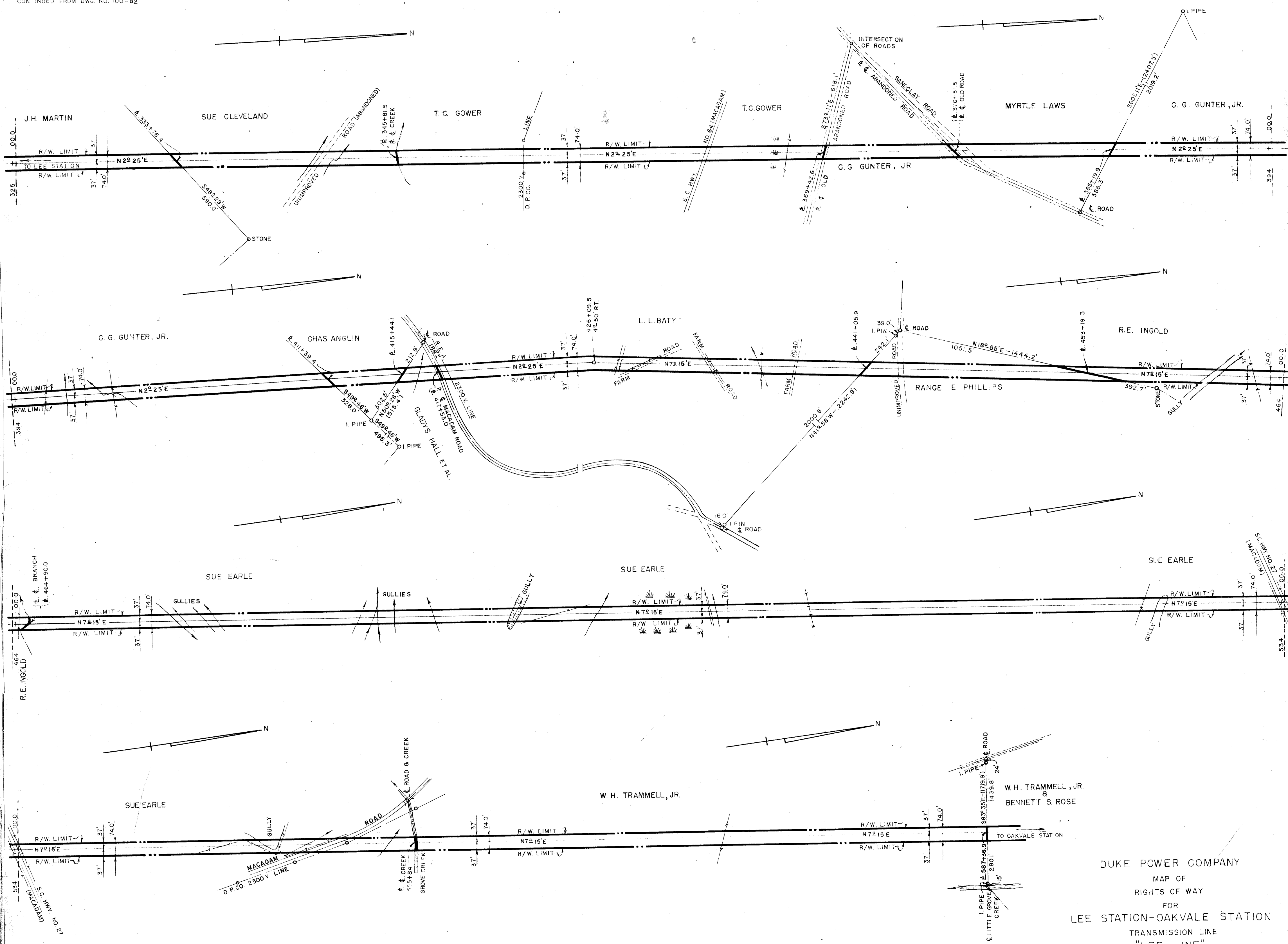

DUKE POWER COMPANY
 MAP OF
 RIGHTS OF WAY
 FOR
 LEE STATION-OAKVALE STATION
 TRANSMISSION LINE
 "LEE LINE"
 GREENVILLE COUNTY, S.C.
 SCALE: 1" = 300'
 JULY 1950
 BOOKS NO. 299 & 303 FILE NO. 100-83

CONTINUED ON DWG. NO. 100-84

#19686 Filed 15th day of Aug 1950
 And Recorded in Vol. 4 Page 43 at
 Cecil Sansworth
 Register Meane Conveyance Greenville County, S.C.

AUG 15 1950
 #19686