

NOTE: IRON PINS AT ALL CORNERS.
 LOTS 12, 13 AND 14 RESERVED FOR COMMERCIAL PURPOSES.
 BUILDING LINES APPLY ONLY TO RESIDENTIAL IMPROVEMENTS.

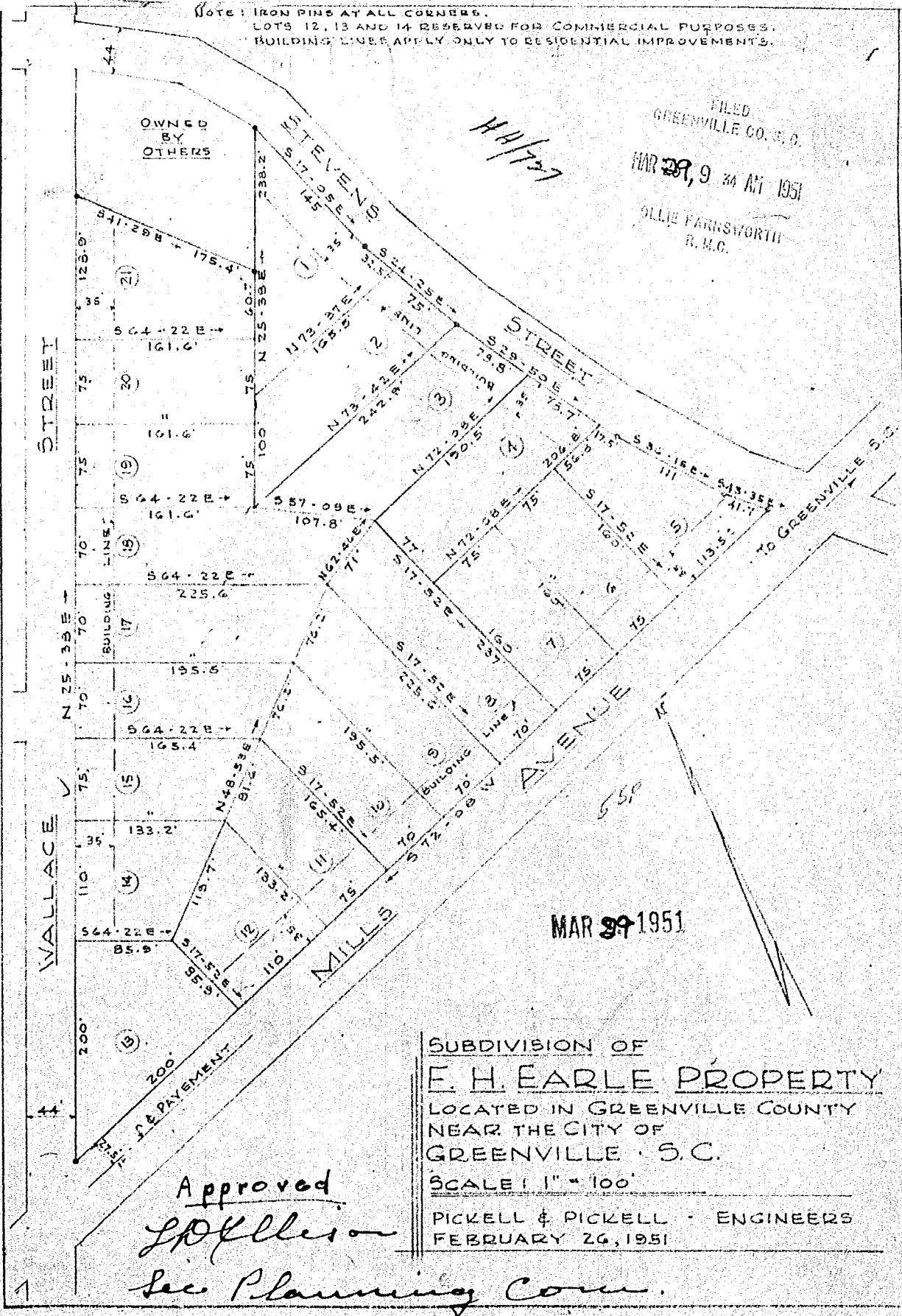

FILED
 GREENVILLE CO. S. C.
 MAR 29 9 34 AM 1951
 OLLIE FARNSWORTH
 R. M. C.

48/737

MAR 29 1951

SUBDIVISION OF
F. H. EARLE PROPERTY
 LOCATED IN GREENVILLE COUNTY
 NEAR THE CITY OF
 GREENVILLE S. C.

SCALE 1" = 100'
 PICKELL & PICKELL - ENGINEERS
 FEBRUARY 26, 1951

Approved
[Signature]
 Sec. Planning Comm.

#7384
 And Recorded in Vol. 7 Page 191
[Signature]
 Register Means Conveyance Greenville County, S. C.

BAD COPY

