

CERTIFICATE OF SURVEY
 I HEREBY CERTIFY THAT THIS IS AN ACCURATE
 MAP OF AN ACTUAL SURVEY COMPLETED BY
 US ON OCTOBER 5, 1954.
 PICKELL & PICKELL - ENGINEERS
 150 W. 11th St. Greenville, S.C.
 REG. S.C. P.E. & L.D. NO. 356

CERTIFICATE OF OWNERS
 WE HEREBY CERTIFY THAT WE ARE THE OWNERS
 OF THE PROPERTY INCLUDED IN THE SUBDIVISION
 SHOWN ON THIS PLAT AND DO APPROVE OF THE
 SUBDIVISION THEREAS SHOWN.

GREENVILLE, S.C.

MILLS MILL
 GRAMMAB SCHOOL

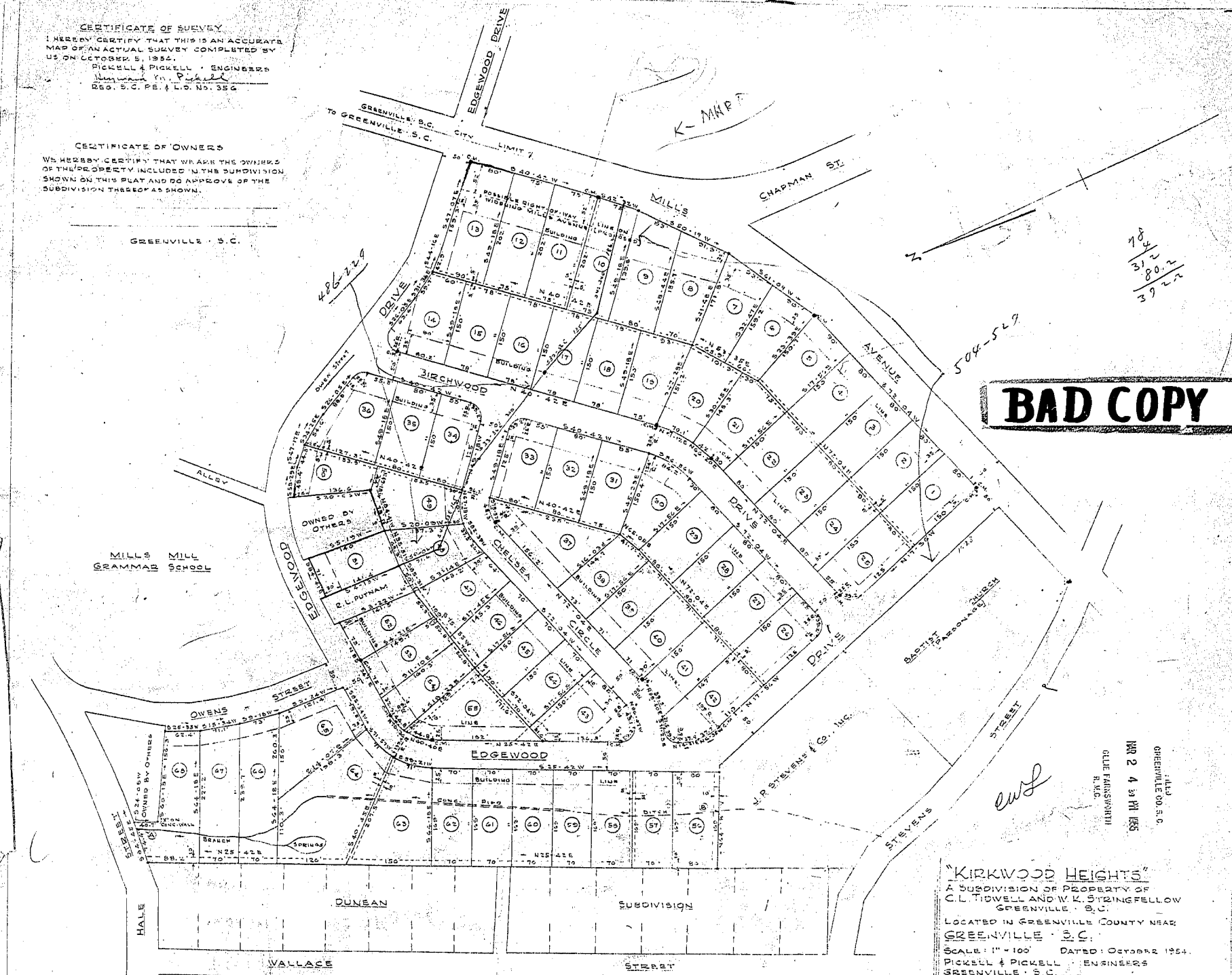

BAD COPY

184
 31
 80.2
 39.22

ewf

"KIRKWOOD HEIGHTS"
 A SUBDIVISION OF PROPERTY OF
 C.L. TOWELL AND W.K. STRINGFELLOW
 GREENVILLE, S.C.
 LOCATED IN GREENVILLE COUNTY NEAR
 GREENVILLE, S.C.
 SCALE: 1" = 100' DATED: OCTOBER 5, 1954.
 PICKELL & PICKELL - ENGINEERS
 GREENVILLE, S.C.

FILED
 GREENVILLE CO., S.C.
 MAR 2 4 31 PM 1955
 GLENN FARGNANTH
 R.M.C.

NOTE:
 SHORT, BROKEN LINES ADJACENT TO REAR AND SIDE LOT LINES
 ARE THE LINES OF EASEMENTS RESERVED FOR UTILITIES AND
 DRAINAGE FACILITIES.
 A FIVE FOOT (5') WIDTH BASEMENT EACH SIDE OF THE CENTER LINE
 OF THE DRAINAGE CHANNELS ACROSS LOTS 32 TO 37, INCLUSIVE, IS
 RESERVED FROM 32 TO 37, SUCH TO FOLLOW ANY RELOCATION AT THE
 LOT LINES FOLLOW THE ARCS AT CURVES. BEARINGS AND DISTANCES
 AT CURVES ARE FOR SURVEY TIE CHORDS ONLY.

MAR 2 - 1955
 5571

FINAL PLAN APPROVED
 GREENVILLE CITY PLANNING & ZONING COMMISSION
 DATE: 3-2-55 BY *Arthur C. Pickens*
 SECRETARY OF COMMISSION